

J. Lance Kilby

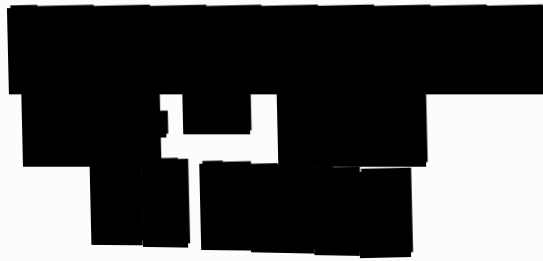

Subject:

Foothills Landscape Project  
Chattahoochee National Forest

To Betty Jewett Forest Supervisor, Ryan Fode District Ranger

I submit this comment in regards to future plans affecting the management of the Chattooga Ranger District. I am in full support of most provisions outlined in the proposal including pine thinnings, oak restoration, and shortleaf reestablishment. I believe these activities are a crucial tool in forest health, wildlife management, water quality as well as rural economic development.

~~I~~ I would like to see more harvest activities in the Rabun, Habersham, & Stephens county areas focusing on Pine Plantation first & second thinnings, small hardwood clearcuts and shelterwood cuts as well as mature white Pine harvest.

However, I do not like the idea of eradicating ~~the~~ planted stands of whitepine & loblolly due to the notion of "nonnative species removal". ~~These~~ These areas should be

need to maturity then the final harvest and restoration process  
begin. Also non productive hardwood stands should be treated  
promote even age/early ~~succession~~ natural regeneration with some  
slash or herbicide treatment early on. This should be harvested  
initially using methods of Clearcut, shelterwood/overstory removal.  
In addition to these request, all Virginia Pine should be removed  
during any and all harvest operations.

In conclusion, I am a lifelong resident and logger/timber buyer  
of Rabun County. For 25 plus years I've see the negative effects  
of non-management policy ~~and~~ fear if we don't change the  
scope of operation the forest, wild life, and water quality will  
suffer to the point of no return. An outspoken minority  
have had a strangle hold on forest activities for far too long  
and hope you can push ~~ahead~~ with this plan and manage  
this forest as it should be. I thank you for your commitment  
to this issue and hope good things are on the horizon.

Feel free to contact me for any questions or comments,

Very Sincerely,

