

# ALASKA

FROM THE  
SOUTHEAST  
COAST TO THE  
WILD BERING SEA

ADVENTURES  
FROM ONE  
WEEK TO EPIC

PLUS  
FREE AIR,  
SOLO SAVINGS  
& EXCLUSIVE  
OPPORTUNITIES



Taylor Bay, ALASKA

59.2913° N, -151.0464° W

# WHEN YOU REALIZE THE KILLER WHALE IS USING YOUR BOAT TO CORRAL ITS PREY AND YOU'RE PART OF THE HUNT.

You know the charge you get when you come upon something wild and unexpected, something rare and beautiful? We live for those moments. We sail to the ends of the earth to find them, to discover them anew, and conjure them for our guests.

**THAT'S THE EXHILARATION OF DISCOVERY**



## TABLE OF CONTENTS

- 2** The Small Ship Experience
- 4** The Perfect Platform
- 6** Where Awesome Is
- 8** Go Your Own Way
- 10** Teamwork: On Land & Undersea
- 12** National Geographic Photography
- 14** Where Families Connect
- 16** Milestones
- 18** Alaska's Coastal Wilderness
- 22** Wild Alaska Escapes
- 26** Inside Passage
- 30** Remarkable Journey
- 34** Bering Sea: Pribilofs, Katmai & Kodiak
- 38** Bering Sea: Katmai to Kamchatka
- 42** Dining Aboard
- 44** *National Geographic Quest and National Geographic Venture*
- 46** *National Geographic Sea Bird and National Geographic Sea Lion*
- 48** *National Geographic Orion*
- 50** Extensions
- 52** Special Offers
- 53** Reservation Information





*National Geographic  
Sea Bird* in Juneau,  
dwarfed by big ships.  
They're bound for the  
next port; *Sea Bird*  
only enters port to  
embark guests.

Dear Traveler,

Thousands of people flock to Alaska each summer to experience its legendary wildness, but only a relative few will actually explore it. The expeditions we offer are for travelers seeking to go beyond the predictable ports and tour spots frequented by cruise ships. Our nimble ships can tuck into secluded coves and harbors and pull within arm's reach of glaciers. And our fleet of expedition landing craft, plus our special access permits, allow us to land along wild shores and venture into communities that have remained deliberately roadless. You'll benefit from our knowledge of the best sites to explore, gained though over 35 years of experience in Alaska, as well as relationships we've established with the ultimate 'insider,' the Alaska Whale Foundation. There's no better way to experience Alaska and all its wildness than on an authentic expedition.

Best regards,



Sven Lindblad, CEO

**A small-ship expedition** means more flexibility, choices, and activities. Guests are never “herded” and there is always a variety of options so that you can choose to do as much—or as little—as you please.



# THE KEY TO GOING WHERE AWESOME IS: OUR FULLY EQUIPPED SHIPS

**NIMBLE EXPEDITION SHIPS THAT CAN GO WHERE LARGER** cruise ships cannot is only part of the authentic expedition experience we offer guests. While the ships enable us to take you in deep where the bears forage, bald eagles soar, and whales spectacularly breach, the cool tools they carry enable you to have your own individual up-close adventures. Our fleet of expedition landing craft, kayaks, and stand-up paddleboards let you experience these wild geographies with all your senses. Landing craft lets us explore virtually everywhere without being dependent on docks, ports, or piers. We can roam freely, feel the swells created by calving glaciers, or land on remote beaches to hike old-growth forests. Our kayaks and paddleboards also let you paddle into quiet inlets to hear the sounds, or observe a family of otters up-close. In addition, you have the freedom to visit the Bridge to watch the captain and officers navigate the thrilling straits, narrows, and bays that make these waters so extraordinary to explore. Unparalleled access is what gives you incredible experiences, stories to share, a priceless stock of memories, and the best photos of your life.

▶ See our **NEW** ship, *National Geographic Venture* [expeditions.com/VENTURE](https://expeditions.com/VENTURE)

“Our new sister ships, *National Geographic Quest* and *National Geographic Venture*, are designed to give a complement of 100 guests the same intimate, inclusive experience the 62-guest *National Geographic Sea Bird* and *National Geographic Sea Lion* have provided for 35 years. They’ve introduced a generation to Alaska, Baja, British Columbia, the San Juan Islands, and more—and to the profound joys of up-close, personal exploring with expert naturalists, and a collegial expedition community. Each one delivers a feeling like no other. And we’re delighted to welcome *National Geographic Orion* to Alaskan waters to explore the remote Bering Sea.”

— CAPTAIN ANDREW COOK  
*National Geographic Venture*





THE WILDNESS OF ALASKA:  
YOUR TRAVEL DREAM IS OUR  
DAILY COMMITMENT







**EXPEDITIONS, BY DEFINITION, ARE JOURNEYS WITH A** purpose. They are led by teams, each member bringing something vital and fresh to the endeavor. Our purpose, quite simply, is to surprise and delight you at every turn. Should a 40-ton humpback whale or a bubble-net feeding pod surface nearby, rest assured, the captain will stop the ship for you to experience its majesty. And you'll have not only knowledgeable naturalists, but possibly a field researcher, at your side for expert commentary. When serendipity strikes, we do what comes naturally to us. We do whatever it takes to put you where the action is. To capture whatever magic nature affords us. To make sure you have an unforgettable experience.



“It’s not always clear just how special these encounters are that you’re having. I can come along and point to a specific individual and say ‘that whale there is 70 years old, the leader of this group and one of the most remarkable individuals anyone has ever observed in the wild.’ Once people start to hear these kinds of things, it really changes the whole whale-watching experience.”

— ANDY SZABO  
Director, Alaska Whale  
Foundation

# YOU'RE ON THE FRONTIER. YOU SHOULD HAVE THE FREEDOM TO EXPLORE AS YOU CHOOSE

**EACH DAY, WE PROVIDE A FRESH SET OF OPPORTUNITIES, ALL** kinds of choices of what to do. Hike, paddleboard, kayak, and more. Hang out on deck with binoculars or with your photo instructor. But should you decide to sleep in, have a relaxing breakfast, and get a massage, nobody will look at you funny. You're on vacation. *Your* vacation. Our schedules are flexible and our itineraries are more a function of what's to see than where we need to be. So, if you want to work up a sweat on a walk, bike, hit the gym, or sit and breathe it all in—do it. It's your adventure. Our generous staff-to-guest ratio means you can always find a naturalist whose interests and approach you share. You're free to explore the ship, find your nook or cranny. And you're always welcome to come up to the Bridge and shoot the breeze with the captain and officers.

## **There is no U in “group.”**

Okay, maybe there is—but only if you want there to be. Our idea of group travel means never being herded like cattle. Each day, you choose what activities interest you, which members of the expedition team you want to join, and what other guests you want to hang out with. You may all be on the same ship but you aren't in the same boat.

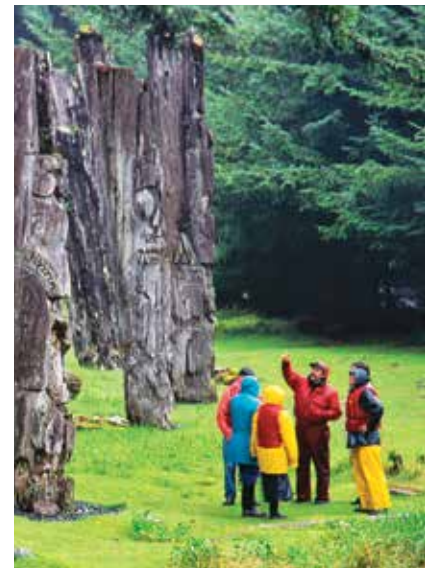





OUR ALASKA TEAMS ARE ACE  
AT DOING WHAT IT TAKES—  
EVEN UNDER THE SEA





**BERING IN KAMCHATKA. JOHN MUIR CIRCA 1879 SEEING** glaciers for the first time. Neither of them have anything on you—you're a natural born Alaska explorer, too. But sometimes even the most intrepid of adventurers need a guide—and that's where we come in. Our team has the knowledge and the passion for Alaska that will kindle yours. They will do whatever it takes, from manning the spotting scopes so you don't miss a single passing whale; lingering as long as you want on deck to watch bubble-net feeding behavior; to offering an extra-long kayak when conditions enable it. And since the undersea is vital to your understanding of Alaska, one will even don cold-water diving gear to explore and shoot video of the surprisingly vivid life beneath our ship to later share in the lounge. They'll help you see, do, and absorb all the extraordinary experiences—in comfort, with inspiration, great conversations, and excellent dining included.



**“ I traveled with my son and the two of us really enjoyed having access to the Bridge. Being able to spend time watching the Captain and officers navigate, or hanging out with the naturalists, admiring their ability to spot and identify birds so swiftly added so much to our experience. Because of this privilege, we felt we really got to see ‘inside’ Alaska. My son got some great photos too.”**

— KEN C,  
Guest

WHAT WILL YOU CREATE WITH  
NATIONAL GEOGRAPHIC  
PHOTOGRAPHERS TO INSPIRE YOU?





**WHILE YOU'RE DISCOVERING ALASKA YOU'LL HAVE THE** benefit of a Lindblad-National Geographic certified photo instructor (CPI) at your side and at your service. He or she can help you with anything from camera settings to the basics of composition. Now, every guest—from smartphone users to advanced DSLR hobbyists—can stand side-by-side with top photographers, pick up tips in the field, and take great photos. Our CPIs are also trained naturalists so they'll help you better understand wildlife behavior. Whether you're choosing a shutter speed to capture a waterfall or framing a killer whale against a killer backdrop, in-the-moment tips from accomplished pros will help you return home with your best photos ever.



**EXCLUSIVE ONBOARD GEAR LOCKER**

Dive into the onboard B&H Photo Video Gear Locker to field test new glass, camera bodies, and more—free. Plus, ask your Expedition Specialist about pre-voyage discounts and benefits.

**NATIONAL GEOGRAPHIC PHOTOGRAPHERS**

Travel with a National Geographic Photographer on select voyages and benefit from their pro knowledge and experience. Select departures are designated photo expeditions (noted on itinerary pages with the 📷 symbol) in which the pace of travel is optimized to maximize opportunities for wildlife encounters, and to cover landscapes in the best possible light. Visit [expeditions.com/photo](https://expeditions.com/photo) for details.

**EXPLORING ALASKA'S COASTAL WILDERNESS (pages 18-21)**

Flip Nicklin – Sep. 1, 2019; May 17, 2020  
Ken Garrett – May 23, 2020  
Krista Rossow – Aug. 22 & 29, 2020

**WILD ALASKA ESCAPE: SITKA TO JUNEAU (pages 22-24)**

Jonathan Kingston – May 17 & 22, 2020  
Rich Reid – Jun. 5 & 20, 2020  
Drew Rush – Jul. 15 & 30, 2020

**WILD ALASKA ESCAPE: JUNEAU TO KETCHIKAN (pages 22-25)**

Rich Reid – Jun. 10 & 15, 2020  
Drew Rush – Jul. 20 & 25, 2020

**TREASURES OF THE INSIDE PASSAGE (pages 26-29)**

Flip Nicklin – Sep. 8, 2019; May 4, 2020  
Ken Garrett – May 10, 2020  
Dan Westergren – Sep. 6, 2020

**A REMARKABLE JOURNEY TO ALASKA, BRITISH COLUMBIA & HAIDA GWAII (pages 30-33)**

Rich Reid – Sep. 2, 2019  
Ronan Donovan – May 3, 2020  
Michael Melford – Sep. 4, 2020

**BERING SEA WILDERNESS (pages 34-37) ACROSS THE BERING SEA (pages 38-41)**

All voyages aboard *National Geographic Orion* have a National Geographic Photographer on board.

# THE MOST EXHILARATING DISCOVERIES ARE THE ONES YOU MAKE TOGETHER

**WHETHER IT'S KAYAKING OFF A SHORE STUDED WITH** foraging bears, or observing whales cooperatively feeding off the ship, we believe shared activities in a wild and exciting environment can bring a family together. Our expeditions are seamless family getaways where everything is taken care of and there are fun, engaging opportunities to explore for kids of all ages. Younger children thrive in the safe, comfortable space of the ship where they can exercise a measure of autonomy. Teenagers and older kids groups often spontaneously form groups to join naturalists and National Geographic certified field educators for nature walks and iPhone photo sessions. And since we believe in sharing Alaska with your kids or grandkids for fun and learning, we're offering the first child at 50% off and the second child free on select 2019 departures.

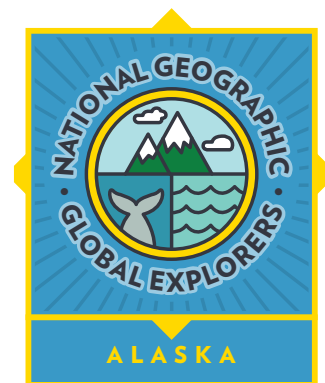

**Our exclusive program for families is the only one of its kind in Alaska travel.** Developed in conjunction with National Geographic Education, it's designed to help kids and their families develop the attitudes, skills, and knowledge of an explorer. Families discover a unique way to explore and connect with each other and the natural world. And kids engage in a variety of cool optional activities, guided by a National Geographic certified field educator. Visit [expeditions.com/family](http://expeditions.com/family) for program details. (Please note program is not available on *National Geographic Orion* voyages.)





GRADUATION



FAMILY REUNION





## ANNIVERSARY

## FOR LIFE—CELEBRATE & SHARE WILDNESS & WONDER

Celebrate your personal achievements and milestones or those of others—the big birthdays, anniversaries, graduations, retirements, vow renewals, or getting the whole clan together—with a life-changing expedition\*. We've seen how sharing the confines of our ship, being wowed by breaching humpbacks, soaring eagles, and salmon-fishing bears tightens the bonds of family or friendship, and amplifies the exhilaration of milestone events. Celebrate as a group of 8 or more with us, and enjoy the following with our compliments:

- A **special gift** in your cabin to welcome you aboard
- **5% savings** on voyage fare
- **\$150 onboard credit**—for an item in the Global Gallery, a treatment in the LEXspa, a bottle of champagne with dinner, or to apply toward your bar tab
- A complimentary **Voyage DVD**
- A **commemorative portrait** of you and yours by the onboard Lindblad-National Geographic Certified Photo Instructor
- A **celebratory cake**, served with flair on the evening you designate

▶ Visit us at [expeditions.com/MILESTONES](https://www.expeditions.com/MILESTONES)

\*Terms & Conditions: For new Exploring Alaska's Coastal Wilderness departure bookings only. Milestone celebration needs to be communicated at time of booking. Group discount is applicable to cruise portion only, and does not apply towards additional services such as hotels, extensions, etc. Group cancellation terms also apply. Not combinable with certain offers. Valid for groups of 8 or more.

EXPLORE ALASKA WITH US: BENEFIT  
FROM 35+ YEARS OF INSIDE KNOW-HOW





ALASKA MAY BE KNOWN AS THE 'LAST FRONTIER,' BUT WE'VE been exploring the region for decades—bringing travelers who long to delve deep into all this remote and rugged land has to offer. On this comprehensive expedition, we seek out spectacular vistas, iconic wildlife, and pervasive wildness—the stuff of legends—like no one else can. Our expert teams, knowledgeable and passionate, plus our intimate, state-of-the-art ships, designed to navigate shallow coves and coastal waters, get you right into wild nature. Sit just off the face of calving tidewater glaciers in Glacier Bay National Park and into mist-shrouded fjords. Spot brown bears foraging along shores and humpback whales breaching. Explore the coast up close by kayak, discover the strange marvel known as a muskeg, learn about the region's rich Tlingit heritage, and much more.

## EXPEDITION HIGHLIGHTS

Hike among lush, old-growth trees in the world's largest temperate rainforest • Keep watch for iconic wildlife—brown bears, killer whales, bald eagles, and more • Explore rugged coastlines and secluded inlets via expedition landing craft • Gain perspective on indigenous people from a Tlingit Cultural Interpreter on select departures • Learn about the local whale population from our conservation partners at Alaska Whale Foundation • Discover the unexpectedly dazzling undersea • Hike and kayak by special permit in wild, remote areas of Tongass National Forest

▶ Visit [expeditions.com/ALASKAWILDERNESS](https://www.expeditions.com/ALASKAWILDERNESS) for itinerary.

Continue your adventure on our Denali extension. See page 50.

▶ Visit [expeditions.com/DENALI](https://www.expeditions.com/DENALI)

**GLACIER BAY NATIONAL PARK**

By special permit—sail the expanse of glaciers, witness icebergs calving, search for sea lions, puffins, and mountain goats. A Native Tlingit interpreter shares local legends and lore.

**ICY STRAIT & THE INIAN ISLANDS**

Hike, kayak, and search for whales in Icy Strait. Cruise among the abundant sea lions of the Inians.

**SOUTHEAST ALASKA'S ISLANDS, BAYS & FJORDS**

With nature as our guide, we'll roam free in iconic wildness. Hike, kayak, and more.

**SITKA**

Visit St. Michael's Orthodox Cathedral. See eagles up close at the Sitka Raptor Center. Disembark for flight home.

**JUNEAU**

Get a feel for Alaska in Juneau at the Alaska State Museum. Then settle into your cabin and explore the ship.

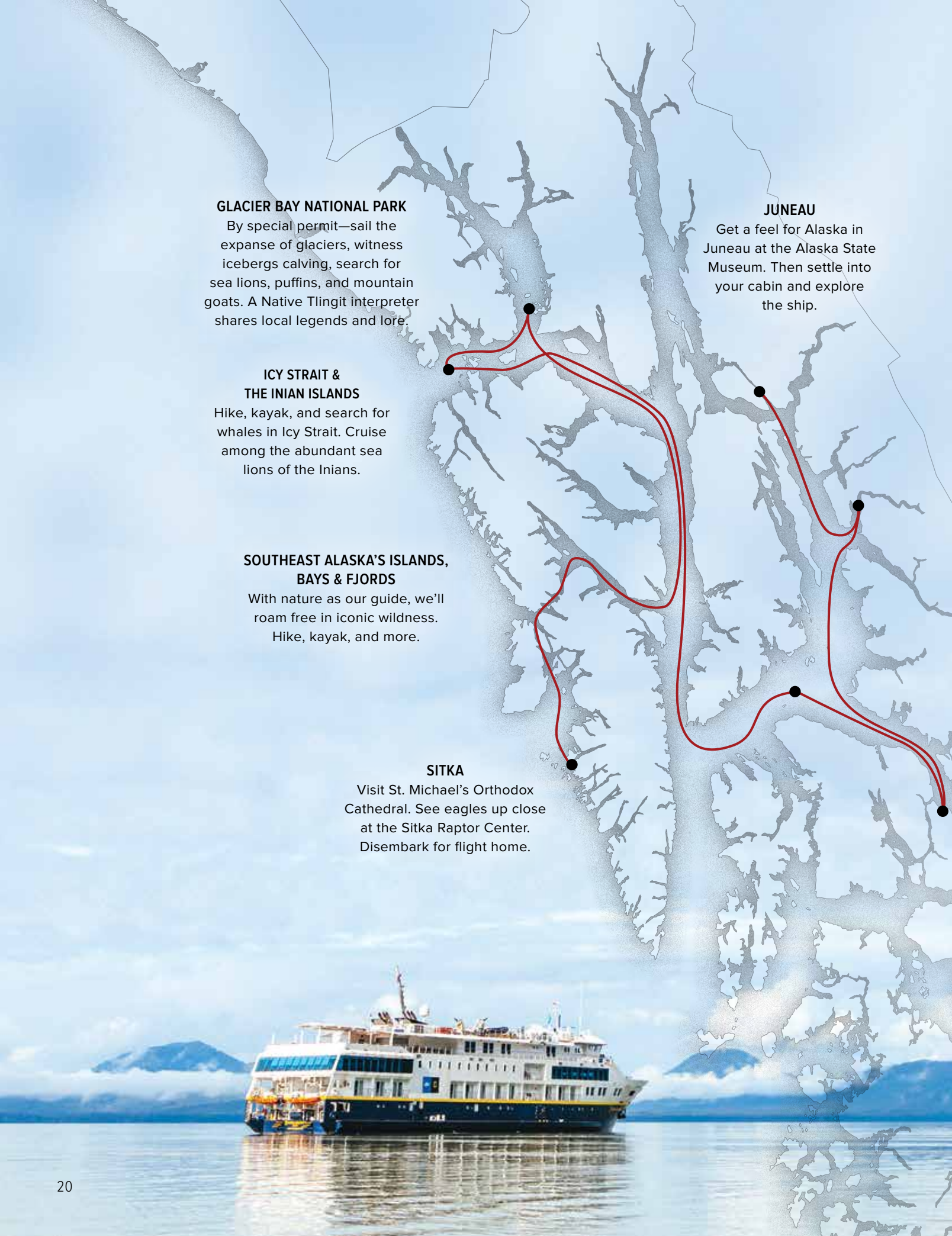

## ITINERARY: EXPLORING ALASKA'S COASTAL WILDERNESS

8 DAYS/7 NIGHTS—ABOARD *NATIONAL GEOGRAPHIC SEA LION*, *NATIONAL GEOGRAPHIC QUEST*, AND *NATIONAL GEOGRAPHIC VENTURE*

FROM: \$5,990 (SEE PAGES 44-47 FOR DETAILS)

### EXPEDITION DETAILS

2019 Dates:

*Sea Lion*: Aug. 3, 10\*, 17; *Venture*: Aug. 18, 25\*; Sep. 1; *Quest*: Aug. 24

2020 Dates:

*Quest/Venture*: From May through August, expeditions depart every week. See our website for specific departure dates.

\*These departures travel in the reverse order from Sitka to Juneau, making all the same stops

### TRACY ARM-FORDS TERROR WILDERNESS

Spectacular fjords with cascading waterfalls. Cruise among sculpted icebergs at Dawes or South Sawyer Glaciers.

### FREDERICK SOUND & PETERSBURG

Search for killer whales, humpbacks, and sea lions. Explore Petersburg's fishing town (Alaska's "Little Norway"). Optional flight-seeing.

### SPECIAL OFFERS:

- Bring a child or grandchild to Alaska for 50% off, and a second child for free on select 2019 departures.
- Book now and receive FREE ROUND-TRIP AIRFARE between Seattle and Alaska on select 2019 departures.
- Book now and we will waive the solo traveler premium on solo cabins on the Aug. 24, 2019 departure.

For these offers, see page 52 or call for details.

### ITINERARY AT A GLANCE

- Day 1: Juneau, Alaska / Embark ship
- Day 2: Tracy Arm-Fords Terror Wilderness
- Day 3: Petersburg
- Day 4: Frederick Sound and Chatham Strait
- Day 5: Icy Strait & the Inian Islands
- Day 6: Glacier Bay National Park
- Day 7: Southeast Alaska's Islands, Bays & Fjords
- Day 8: Sitka / Disembark

*The National Geographic Sea Lion visits the outer bays of Glacier Bay National Park and does not enter the permitted part of the Bay.*

- ▶ Visit [expeditions.com/ALASKAWILDERNESS](https://expeditions.com/ALASKAWILDERNESS) for a complete day-by-day itinerary. Or call to speak with an Expedition Specialist.

### OPTIONAL EXTENSIONS

Add a 6-day pre- or post-voyage inland adventure to explore Denali National Park from the North Face Lodge. Visit [expeditions.com/denali](https://expeditions.com/denali) or see page 50.

FROM JUNEAU HEAD NORTH  
OR GO SOUTH—OR DO BOTH







OUR NEW-IN-2018, 6-DAY *WILD ALASKA ESCAPE: SITKA TO JUNEAU* proved very popular. Highly active, it delivers a thrilling experience of Southeast Alaska—hitting the iconic highlights in an ideal timeframe for families, vacationers, and those who want authentic Alaska in less time. It also kindled memories for several veteran staffers, reminding them of when our ships sailed from Prince Rupert, plying narrow channels like Behm and Blake, Walker Cove in Misty Fjords, Eastern Passage, and Wrangell Narrows. We navigated straits and inlets to discover an authentic Alaska unreachable by big white boats. We lowered expedition landing craft to explore places like Hole in The Wall Marine Park on Prince of Wales Island, and dropped kayaks into salmon-studded waters, to trace the rugged, wildlife-rich shorelines of Kupreanof and Kuiu Islands. So, we decided to do it again with our new *Wild Alaska Escape: Juneau to Ketchikan*—to discover more off-the-beaten-track Alaskan wonders, and legendary sites.

This offers you, the prospective traveler, a choice in how to experience Southeast Alaska. Explore from Sitka to Juneau; or from Juneau to Ketchikan. Or, elect to do both and experience double the sights, sightings, and wildness.

Elect to take both expeditions and you'll **save 10% on the combined price**. We invite you to speak with an Expedition Specialist for details.

### EXPEDITION HIGHLIGHTS

Visit bustling Alaskan port cities • Keep watch for iconic wildlife—killer whales, humpback whales, brown bears, bald eagles, and more • Kayak rugged coastlines, calm coves, and secluded inlets • Gain perspective on the region's indigenous people • Hike among old-growth trees in the world's largest temperate rainforest

▶ Visit [expeditions.com/ALASKA](https://www.expeditions.com/ALASKA) for itineraries.

# ITINERARY: WILD ALASKA ESCAPE: SITKA TO JUNEAU

6 DAYS/5 NIGHTS—ABOARD  
*NATIONAL GEOGRAPHIC SEA BIRD*  
AND *NATIONAL GEOGRAPHIC SEA LION*

FROM: \$4,390

(SEE PAGES 46-47 FOR DETAILS)

## EXPEDITION DETAILS

2019 Dates: Aug. 13, 18\*, 23, 28\*

2020 Dates: From May through August, expeditions depart every week. See our website for specific departure dates.

📷 2020 Photo Expeditions: Jun. 5, 20\*; Jul. 15, 30\*

\*These departures travel in the reverse order, from Juneau to Sitka, making all the same stops.

### SPECIAL OFFERS:

- Book now and receive FREE ROUND-TRIP AIRFARE between Seattle and Alaska on the Aug. 18 and 23, 2019 departures. PLUS waive the premium on solo cabins for solo travelers on these departures. See page 52 or call for details.

## ITINERARY AT A GLANCE

- Day 1: Sitka / Embark  
Day 2: Exploring Baranof or Chichagof Island  
Day 3: Icy Strait & the Inian Islands  
Day 4: Haines  
Day 5: Tracy Arm—Fords Terror Wilderness  
Day 6: Juneau

▶ Visit [expeditions.com/WILDALASKANORTH](https://www.nationalgeographic.com/expeditions.com/WILDALASKANORTH) for a complete day-by-day itinerary. Or call to speak with an Expedition Specialist.

### GLACIER BAY NATIONAL PARK

Enjoy an included flightseeing excursion over the expansive Glacier Bay National Park.

### ICY STRAIT & THE INIAN ISLANDS

Hike, kayak, and search for whales in Icy Strait. Cruise among the abundant sea lions of the Inians.

### CHICHAGOF ISLAND

Take a shoreline hike or kayak coves and inlets to spot wildflowers, waterfalls, and wildlife—from bald eagles to colorful sea stars.

### SITKA

Meet eagles at the Raptor Rehabilitation Center and admire the picturesque spire of Saint Michael's Russian Orthodox Cathedral.

### KETCHIKAN

View 19th-century Tlingit totem poles at the Totem Heritage Center and explore the local port with its vast fishing fleet and thriving commercial fishery.





**HAINES**

Get active in the adventure capital of Alaska—go mountain biking, hike world-class trails, or raft the Chilkat River to a bald eagle preserve.

**JUNEAU**

Explore Alaska’s capital city, first settled by gold miners in the 1880s, and the surrounding wilderness.

**TRACY ARM-FORDS TERROR WILDERNESS**

Spectacular fjords with cascading waterfalls. Cruise among sculpted icebergs at Dawes or South Sawyer Glaciers.

**LECONTE GLACIER OR THOMAS BAY**

Enter one of these iceberg-littered bays aboard our nimble ship, then if conditions permit set out to explore by expedition landing craft or walk along the shoreline among the ice sculptures stranded on the beach.

**WRANGELL**

Explore the remote town of Wrangell on Wrangell Island, where the indigenous Tlingit people have made their home for thousands of years. Visit a tribal house and a beach famous for native petroglyphs, or take an optional jet boat excursion up the Stikine River.

**SUMNER STRAIT**

Explore along the rugged coastlines of Kupreanof, Kuiu, or Prince of Wales Islands seeking out humpbacks and other wildlife along the shoreline.

**BEHM CANAL & MISTY FJORDS**

Scan the water for otters and killer whales as you breathe in the scent of Sitka spruce and cedar from the surrounding forest.

**ITINERARY: WILD ALASKA ESCAPE: JUNEAU TO KETCHIKAN**

**6 DAYS/5 NIGHTS—ABOARD NATIONAL GEOGRAPHIC SEA LION**

**FROM: \$4,420**

(SEE PAGES 46-47 FOR DETAILS)

**EXPEDITION DETAILS**

2020 Dates: May 21, 26\*; Jun. 10📷, 15📷\*, 30; Jul. 5\*; 20📷, 25📷\*; Aug. 9, 14\*

📷 Photo Expeditions

\*These departures travel in the reverse order, from Ketchikan to Juneau, making all the same stops.

**SPECIAL OFFERS:**

- Elect to take both itineraries and save 10% on the combined price.

**ITINERARY AT A GLANCE**

- Day 1: Juneau
- Day 2: LeConte Glacier / Thomas Bay
- Day 3: Exploring Sumner Strait
- Day 4: Wrangell
- Day 5: Behm Canal / Misty Fjords National Monument
- Day 6: Ketchikan

▶ Visit [expeditions.com/WILDALASKASOUTH](https://expeditions.com/WILDALASKASOUTH) for a day-by-day itinerary. Or call to speak with an Expedition Specialist.

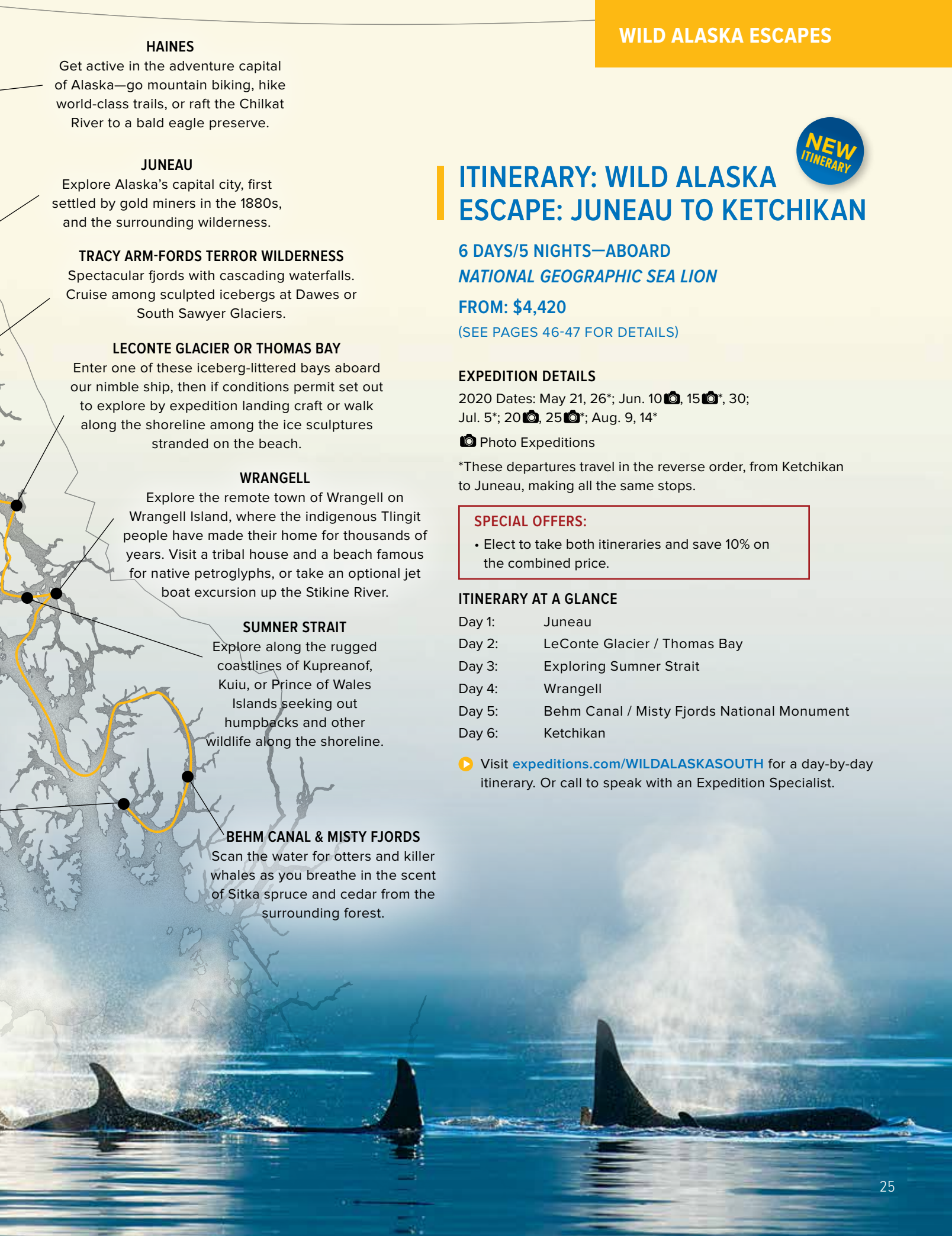

LINGER ALONG A SELDOM-SEEN COAST  
ON A SWEEPING INSIDE PASSAGE ROUTE





**PART OF THE LONGEST COASTLINE IN THE WORLD, THE** Pacific stretches from Washington's San Juan Islands north, to Southeast Alaska's Glacier Bay National Park, navigates through several geographies, ecosystems, and notable landmarks. Following this route, our expedition balances cultural facets of the ancient and modern—First Nations performances in Alert Bay and the charming capital city of Victoria, British Columbia—with hikes through temperate rainforests in the Tongass National Forest; massive, blue-tinted glaciers; picturesque, island-dotted waterways; and myriad opportunities to spot brown bears, whales, seabirds, and more.

### EXPEDITION HIGHLIGHTS

**Kayak and hike among the wild San Juan and Gulf Islands • See a moving First Nations' performance at the U'mista Cultural Center • Enter Glacier Bay National Park by special permit • Explore Victoria your way—choose a private garden tour, bike the waterfront, stroll the historic Old Town, and more • View incredible wildlife artwork at a private reception at The Robert Bateman Centre**

▶ Visit [expeditions.com/TREASURES](https://www.expeditions.com/TREASURES) for itinerary.

Continue your adventure on our Denali extension. See page 50.

▶ Visit [expeditions.com/DENALI](https://www.expeditions.com/DENALI)

**GLACIER BAY NATIONAL PARK**  
Listen as the wilderness silence is broken by the thunder of the region's enormous glaciers calving ice into the sea.

**INIAN ISLANDS**  
Hop in a Zodiac and keep watch for the abundance of Steller sea lions that reside in this island cluster.

**ICY STRAIT**  
With special permission from the US Forest Service, hike the nearby islands with a naturalist and kayak the wildlife-rich water, searching for whales.

**SITKA**  
Meet eagles at the Raptor Rehabilitation Center and admire the picturesque spire of Saint Michael's Russian Orthodox Cathedral.

**TRACY ARM**  
Voyage into Tracy Arm, a spectacular fjord featuring waterfalls that cascade from the sharply sloping walls, and see just how blue the South Sawyer Glacier is up close.

**FREDERICK SOUND**  
Observe feeding humpback whales that visit this channel for its herring-filled waters.

**PETERSBURG**  
Stroll this charming, 100-year-old town—supported largely by fishing—and note the evident Norwegian influences.

**MISTY FJORDS NATIONAL MONUMENT**  
Kayak the waters of this protected region, breathing in the deep-forest scents of Sitka spruce and cedar, reveling in the stillness.

**SAN JUAN ISLANDS**  
Watch for killer whales as you Zodiac cruise the waters of this archipelago where the whales live all year round.

**VICTORIA**  
Enjoy private gardens and art galleries, waterfront strolls, and fine cuisine in this Canadian capital city.

## ITINERARY: TREASURES OF THE INSIDE PASSAGE: ALASKA & BRITISH COLUMBIA

14 DAYS/13 NIGHTS—ABOARD *NATIONAL GEOGRAPHIC QUEST* AND *NATIONAL GEOGRAPHIC VENTURE*

FROM: \$9,990

(SEE PAGES 44-45 FOR DETAILS)

### EXPEDITION DETAILS

2019 Dates: Aug. 31\*, Sep. 8\*

2020 Dates: May 4, 10; Aug. 29; Sep. 6\*

\*These departures travel in the reverse order, from Sitka to Seattle, making all the same stops.

### SPECIAL OFFERS:

- Book now and receive free one-way air (Sitka/Seattle) on all 2019 & 2020 departures. Plus we will waive the solo premium on solo cabins on the Aug. 31, 2019 voyage. See page 52 or call for details.

### ITINERARY AT A GLANCE

- |           |                                       |
|-----------|---------------------------------------|
| Day 1:    | Seattle / Embark                      |
| Day 2:    | San Juan Islands, Washington          |
| Day 3:    | Victoria, British Columbia            |
| Day 4:    | Gulf Islands                          |
| Day 5:    | Alert Bay and Johnstone Strait, B.C.  |
| Days 6-7: | Inside Passage of British Columbia    |
| Day 8:    | Misty Fjords, Alaska                  |
| Day 9:    | Petersburg                            |
| Day 10:   | Tracy Arm-Fords Terror Wilderness     |
| Day 11:   | Glacier Bay National Park             |
| Day 12:   | Inian Islands / Icy Strait            |
| Day 13:   | Exploring Baranof or Chichagof Island |
| Day 14:   | Sitka / Disembark / Home              |

- ▶ Visit [expeditions.com/TREASURES](https://www.expeditions.com/TREASURES) for a complete day-by-day itinerary. Or call to speak with an Expedition Specialist.

### ALERT BAY

Observe a traditional First Nations performance, visit their Big House, and learn from the Kwakwaka'wakw people.

### GULF ISLANDS

Paddle myriad islets and rocky coasts—a kayaker's paradise—as you keep watch for harbor seals and an array of seabirds, shore birds, and birds of prey.

### SEATTLE

Arrive in this coastal city and embark ship in the afternoon.

DISCOVER LEGENDARY HAIDA GWAI  
AND ENJOY PRIVILEGED ACCESS





OUR 15-DAY EXPEDITION BETWEEN SEATTLE, WASHINGTON, and Sitka, Alaska, explores three of the most intriguingly wild regions of the Pacific Northwest: Alaska's Inside Passage, coastal British Columbia, and Haida Gwaii. On our in-depth exploration, sail into mist-shrouded fjords and past crashing glaciers. Watch for brown bears stalking shores, and bald eagles soaring. And by special permission granted to our company and ship, spend four days in the Haida Gwaii archipelago, exploring lands sacred to the Haida nation, and interacting with the region's legendary artisans. Haida cultural interpreters invite you to discover a wealth of cultural objects, songs, and stories; the sites of their ancient villages; and, along the shore in sacred SGang Gwaay Llanagaay, the iconic and masterfully-carved totems—some of which have been standing for hundreds of years.

### EXPEDITION HIGHLIGHTS

Sail deep into mazes of glacier-carved fjords • Watch for abundant and varied wildlife on land and in the sea and sky • Visit Haida Gwaii, the protected ancestral home of the Haida people, and enjoy privileged access to SGang Gwaay, a UNESCO World Heritage Site • Take part in a traditional indigenous dance performance • Hike old-growth forests and kayak spectacular bays • Capture the best photos of your life with tips from the certified photo instructor on board • Marvel at the unexpectedly vibrant undersea via video shot by our undersea specialist

▶ Visit [expeditions.com/REMARKABLE](https://www.expeditions.com/REMARKABLE) for itinerary.

Continue your adventure on our Denali extension. See page 50.

▶ Visit [expeditions.com/DENALI](https://www.expeditions.com/DENALI)

**GLACIER BAY NATIONAL PARK**  
Enjoy this protected region's beautiful wilderness scenes plus local legend and lore, shared by a native Tlingit interpreter.

**INIAN ISLANDS**  
Hop in a Zodiac and keep watch for the abundance of Steller sea lions that reside in this island cluster.

**SITKA**  
See the picturesque city of Sitka on Baranof Island and meet eagles at the Raptor Rehabilitation Center.

**HAIDA GWAI**  
With our special access, discover these remote islands and the incredible history of the Haida people alongside our local cultural interpreters.

**OLD MASSETT**  
Participate in a Haida feast of traditional food and dance at the home of a local carver in this ancestral town.

**SGANG GWAAY**  
See the ancient, shoreline totems—some of which have been standing for hundreds of years—carved by the region's renowned Haida artisans.

**ICY STRAIT**  
With permission of the US Forest Service, hike the nearby, forested islands with a naturalist and kayak the surrounding waters, searching for whales and other marine wildlife.

**TRACY ARM**  
Cruise and kayak this spectacular, glacier-carved fjord which features large amounts of floating ice ranging from hand-sized pieces to pieces as large as houses.

**FREDERICK SOUND**  
Observe humpback whales that have migrated from Hawaii as they feed on the herring and krill found here.

**MISTY FIORDS**  
Kayak the calm waters of this protected forest region and enjoy the scents of Sitka spruce and cedar that permeate the air.

**SKIDEGATE**  
Visit the award-winning Haida Heritage Centre and Museum.

**GULF ISLANDS**  
Search for some of the many marine mammals—dolphins, whales, harbor seals—that inhabit the waters surrounding these lush islands.



## ITINERARY: A REMARKABLE JOURNEY TO ALASKA, BRITISH COLUMBIA & HAIDA GWAII

15 DAYS/14 NIGHTS—ABOARD *NATIONAL GEOGRAPHIC SEA BIRD* AND *NATIONAL GEOGRAPHIC SEA LION*

FROM: \$10,900

(SEE PAGES 46-47 FOR DETAILS)

### EXPEDITION DETAILS

2019 Dates: Aug. 24\*; Sep. 2\* 📷

2020 Dates: May 2, 3 📷; Sep. 4\* 📷, 5\*

📷 Photo Expedition

\*This departure travels in the reverse order, from Sitka to Seattle, making all the same stops.

### SPECIAL OFFERS:

- Book now and receive free one-way air (Sitka/Seattle) on 2019 & 2020 departures. Plus we will waive the solo premium on solo cabins on the Sep. 2, 2019 voyage. See page 52 or call for details.

### ITINERARY AT A GLANCE

Day 1:	Seattle / Embark
Day 2:	Gulf Islands, British Columbia
Day 3:	Johnston Strait and Alert Bay, British Columbia
Days 4-5:	Inside Passage of British Columbia
Days 6-9:	Haida Gwaii
Days 10-12:	Alaska's Inside Passage
Days 13-14:	Glacier Bay National Park / Inian Islands / Chichagof Island
Day 15:	Sitka / Disembark / Seattle

- ▶ Visit [expeditions.com/REMARKABLE](https://www.expeditions.com/REMARKABLE) for a complete day-by-day itinerary. Or call to speak with an Expedition Specialist.

### BRITISH COLUMBIA

#### ALERT BAY

Watch traditional First Nations performances and learn about the art and culture of the Kwakwaka'wakw people at the U'mista Cultural Centre.

SEATTLE

A large colony of seals, likely Steller sea lions, is gathered on a rocky beach. The seals are densely packed, with many looking towards the camera. The lighting is warm, suggesting late afternoon or early morning. The text "DISCOVER A RARE WILD ALASKA ON A ROUTE THROUGH THE BERING SEA" is overlaid in white, sans-serif font across the upper middle of the image.

DISCOVER A RARE WILD ALASKA ON  
A ROUTE THROUGH THE BERING SEA



**EXPERIENCE A SELDOM-SEEN SIDE OF ALASKA ON THIS**

13-day voyage that sails from the far northern city of Nome. Cross the iconic Bering Strait for a stop in Provideniya, Russia—the Gateway to the Arctic—and revel in the proximity of two such different worlds. Traverse the Bering Sea as *National Geographic Orion* heads south to explore remote and rugged islands dotting the route, including the Pribilof Islands, which serve as the breeding ground for millions of seabirds and marine mammals; Unalaska, the site of a fierce WWII battle; Unga, known for its scattered remains of a petrified forest; and coastal Katmai National Park, where brown bears are frequently spotted digging for clams or catching salmon.

**EXPEDITION HIGHLIGHTS**

Cross the iconic Bering Strait • Witness a traditional Yupik dance performance in Provideniya, Russia • Look for whiskered auklets in the Baby Islands • Walk among the scattered remains of a petrified forest on the shore of Unga Island • Observe foraging brown bears • Witness the largest breeding rookery of northern fur seals, comprising about half the world's fur seal population

▶ Visit [expeditions.com/BERINGSEA](https://www.expeditions.com/BERINGSEA) for itinerary.



**RUSSIA**

**PROVIDENIYA, RUSSIA**

Enjoy a traditional Yupik dance performance and a visit to a museum that highlights local history in this Gateway to the Arctic.

**NOME**

Embark ship in this far northern city that sits at the southern coast of the Seward Peninsula and marks the finish line of the Iditarod, the extreme 1,049-mile sled dog race.

**ALASKA**

*Bering Sea*

**KATMAI NATIONAL PARK**

Spot and photograph bears in their natural habitat where you'll likely catch them digging for clams on the beaches or catching fish in the coastal waters.

**PRIBILOF ISLANDS**

Go ashore at these remote Alaskan islands where millions of seabirds and marine mammals—predominantly northern fur seals—come to breed each summer.

**UNALASKA**

Visit Dutch Harbor, the site of a fierce WWII battle, and watch for sea otters, Steller sea lions, and rare seabirds in the Baby Islands.

**SHUMAGIN ISLANDS**

Walk through beautiful green tundra and a beach dotted with the scattered remains of a petrified forest in this picturesque archipelago.



## ITINERARY: BERING SEA WILDERNESS: PRIBILOFS, KATMAI & KODIAK

13 DAYS/12 NIGHTS—ABOARD *NATIONAL GEOGRAPHIC ORION*

FROM: \$17,040

(SEE PAGES 48-49 FOR DETAILS)

### EXPEDITION DETAILS

2020 Date: Jul. 5

#### SPECIAL OFFER:

- We will cover your bar tab and tips to the crew.

### ITINERARY AT A GLANCE

Jul. 5:	Anchorage / Nome / Embark
Jul. 6:	At Sea / Crossing the Bering Strait
Jul. 7:	Provideniya, Russian Federation
Jul. 8-10:	At Sea / Pribilof Islands
Jul. 11-12:	Unalaska / Alaska Peninsula
Jul. 13:	Shumagin Islands
Jul. 14:	Katmai National Park
Jul. 15:	Kodiak Island
Jul. 16:	Exploring the Kenai Peninsula
Jul. 17:	Seward / Disembark / Anchorage / Home

- ▶ Visit [expeditions.com/BERINGSEA](https://expeditions.com/BERINGSEA) for a complete day-by-day itinerary. Or call to speak with an Expedition Specialist.

### OPTIONAL EXTENSIONS

Add a four-night post-voyage extension at Tutka Bay Lodge on the picturesque Kenai Peninsula, or at Winterlake Lodge set in the foothills of the Alaskan Range. For more information on visiting these National Geographic Unique Lodges of the World, see page 51 or visit [expeditions.com/TUTKABAY](https://expeditions.com/TUTKABAY) or [expeditions.com/WINTERLAKE](https://expeditions.com/WINTERLAKE)

#### SEWARD

Disembark ship and transfer to Anchorage for flights home.

#### KODIAK ISLAND

The second largest island in the United States, Kodiak is best known for its brown bears and its commercial fishing industry.



EXPLORE PRISTINE SELDOM-SEEN  
ISLANDS AND COASTS ON A NEAR  
CIRCUMNAVIGATION OF THE BERING SEA







**EMBARK ON A VOYAGE OF DISCOVERY IN ONE OF THE**

planet's most rugged and wildlife-rich regions that's seldom explored. Covering more than 3,800 nautical miles over 22 days, you'll have the luxury of time to linger in the Aleutian Islands among the great variety of whales that come here in summer. And you'll be able to venture along the rugged coast of Russia to the gateway of the Arctic to see vast colonies of millions of seabirds, wild and pristine rivers, and meet some of the people of the area and learn about their ways of life that including reindeer herding. Throughout you'll see wildlife galore, from coastal brown bears in Katmai National Park and along the Kamchatka Peninsula to marine mammals in the Aluetians including Pacific walrus, northern fur seals, Steller sea lions and much more.

**EXPEDITION HIGHLIGHTS**

See gray, humpback, and sperm whales and other marine mammals like Pacific walrus, northern fur seals, sea otters, and Steller sea lions • Marvel at cliffs teeming with millions of seabirds—from horned and tufted puffins to murres and rare whiskered auklets • Explore the pristine Zhupanova River of rugged Kamchatka and search for Steller's sea eagles • See brown bears in Katmai National Park • Visit a Koryak village in Kamchatka • See Vitus Bering's gravesite in the Commander Islands

▶ Visit [expeditions.com/KAMCHATKA](https://www.expeditions.com/KAMCHATKA) for itinerary.

# ITINERARY: ACROSS THE BERING SEA: FROM KATMAI TO KAMCHATKA

22 DAYS/21 NIGHTS—ABOARD *NATIONAL GEOGRAPHIC ORION*

FROM: \$27,140

(SEE PAGES 46-47 FOR DETAILS)

## EXPEDITION DETAILS

2020 Jun. 14; Jul. 17

## ITINERARY AT A GLANCE

- Day 1: Anchorage/Seward/Embark
- Days 2-3: Katmai National Park
- Days 4-5: At Sea/Unalaska
- Days 6-10: Exploring the Aleutian Islands
- Day 11: Petropavlovsk-Kamchatskiy, Russian Federation
- Day 12: Zhupanova River
- Days 13-14: Commander Islands
- Days 15-19: Exploring the Koryak and Chukotka Coasts
- Day 20: Provideniya
- Day 21: At Sea, Crossing the Bering Strait
- Day 22: Nome/Disembark/Anchorage/Home

▶ Visit [expeditions.com/KAMCHATKA](https://expeditions.com/KAMCHATKA) for a complete day-by-day itinerary. Or call to speak with an Expedition Specialist.

## OPTIONAL EXTENSIONS

Add a four-night post-voyage extension at Tutka Bay Lodge on the picturesque Kenai Peninsula, or at Winterlake Lodge set in the foothills of the Alaskan Range. For more information on visiting these National Geographic Unique Lodges of the World, see page 51 or visit [expeditions.com/TUTKABAY](https://expeditions.com/TUTKABAY) or [expeditions.com/WINTERLAKE](https://expeditions.com/WINTERLAKE)

## RUSSIA

### KORYAK COAST

Hike the bays, tundra, and volcanic mountains of the seldom-seen Russian Far East and learn about reindeer herding culture.

### COMMANDER ISLANDS

See whales and sea otters, and visit the gravesite of legendary Danish explorer Vitus Bering.

### PETROPAVLOVSK

Sail across the International Date Line into the port city of Petropavlovsk, framed by the stunning Kozelsky volcanos.

### ATTU

Explore the site of a WWII battle where U.S. and Japanese forces clashed for three weeks fighting for control of the North Pacific.



**ALASKA**

**NOME**

Disembark ship in this far northern city that sits at the southern coast of the Seward Peninsula and marks the finish line of the Iditarod, the extreme 1,049-mile sled dog race.

**PROVIDENIYA**

Enjoy a traditional Yupik dance performance and visit a museum highlighting local history in this Gateway to the Arctic.

**CHUKOTKA COAST**

Explore seldom-seen coasts and islands teeming with brown bears, walruses, and three species of seals.

**KATMAI NAT. PARK**

Spot and photograph bears in their natural habitat as they walk the shoreline to dig for clams and catch fish.

**ANCHORAGE**

**SEWARD**

Embark the ship in this port city surrounded by peaks.

**KISKA**

Discover the rugged, volcanic Aleutian Islands home to vast colonies of seabirds and a variety of whales.

**UNALASKA**

Explore Dutch Harbor, the site of a fierce WWII battle, now the domain of sea otters, Steller sea lions, and rare seabirds.

WITH LOVE: SERVING SUSTAINABLE  
SEAFOOD & PRODUCE FROM  
LOCAL PROVIDERS





**RESPONSIBLE FOR LAUNCHING THE FIRST-** ever farm-to-table program in Galápagos, our Director of Hotel Services, Ana Esteves, is bringing her fresh approach to Alaska. Committed to sustainable seafood and regional produce, our culinary program is rooted in relationships with our providers, many of whom have been working with us for decades. Fresh-off-the-boat fish, Dungeness crab for

our spectacular crabfest, and salmon sticks to delight kids. Summer berries from coastal farms, and local craft beers—the food on our ships opens new windows on Alaska for you. The exhilaration you feel at seeing breaching whales and calving glaciers? Our dedicated galley team feels it too, and their excitement is in every meal they serve, nourishing your mind, body and spirit, and creating daily discoveries.



# NATIONAL GEOGRAPHIC QUEST & NATIONAL GEOGRAPHIC VENTURE

**CAPACITY:** 50 cabins accommodating 100 guests  
**REGISTRY:** United States. **OVERALL LENGTH:** 238 feet.

Sister ships *National Geographic Quest* and *National Geographic Venture* (launched 2018) are the latest additions to our fleet. Designed with over 50 years of expedition heritage and built in the U.S.A., both ships will set a new standard in exploration and comfort.

**PUBLIC AREAS:** Global gallery; fitness center; LEXspa; lounge with full service bar and facilities for films and presentations; observation deck; mudroom with lockers for expedition gear, and a partially covered sundeck with chairs and tables. Our “open bridge” provides guests an opportunity to meet our officers and captain and learn about navigation.

**MEALS:** Served in single seatings with unassigned tables for an informal atmosphere and easy mingling. Breakfast and lunch are wide-selection buffets with chef-action stations, while dinners are primarily served plated. Menu emphasizes local fare.

**CABINS:** All cabins face outside with windows or portholes, private facilities, and climate controls. Category 4 cabins have step-out balconies.

**EXPEDITION EQUIPMENT:** A fleet of 8 Zodiacs and 24 kayaks, Remotely Operated Vehicle (ROV), hydrophone, splash-cam, underwater video camera, video microscope, paddleboards.

**SPECIAL FEATURES:** Guest internet access, elevator, Lindblad-National Geographic certified photo instructor, a video chronicler and undersea specialist.

**WELLNESS:** The vessel is staffed by a Wellness Specialist and features a gym with an elliptical machine, treadmill, exercycles, handweights and resistance bands. Treatments in the LEXspa are available by appointment.

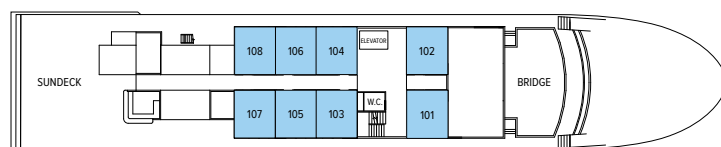

OBSERVATION DECK

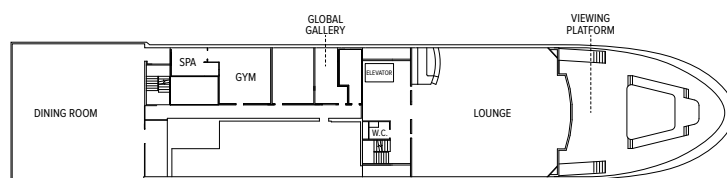

LOUNGE DECK



UPPER DECK

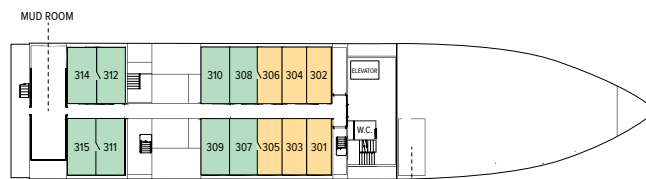

MAIN DECK



Left to right: Captain Cook raises a glass; *National Geographic Venture*; our lounge is the hub of the expedition community; viewing platform; Category 5 cabin; Category 4 cabin with lower single beds (which can be converted to a Queen) and a private step-out balcony. Select cabins connect via an inside doorway.

**CATEGORY 1:** Main Deck #301-306 Cabins feature two lower single beds that can convert to a Queen, a writing desk, and two portholes.

**CATEGORY 2:** Main Deck #307-315 Cabins feature two lower single beds that can convert to a Queen, a writing desk, and two portholes.

**CATEGORY 3:** Upper Deck #201-206 Cabins feature two lower single beds that can convert to a Queen, a writing desk, and two large view windows.

**CATEGORY 4:** Upper Deck #207-229 Cabins feature two lower single beds that can convert to a Queen, a writing desk, sliding glass door, and small, private balcony.

**CATEGORY 5 (SUITE):** Observation Deck #101-108 Cabins feature two lower single beds that can convert to a Queen, large view windows, an expanded bathroom, writing desk, ample storage space, and a convertible sofa bed to accommodate a third person.

**NOTE:** Solo Occupancy cabins are available in Categories 1 and 2 only. Third person rates are available in Category 5 cabins at one half the double occupancy rate.

**Connecting Cabins via internal doorway access:** Main Deck: #312-314, #311-315, #306-308, #305-307; Upper Deck: #224-226, #225-227

Prices are per person, double occupancy unless indicated as solo.

ITINERARY	YEAR	CAT. 1	CAT. 2	CAT. 3	CAT. 4	CAT. 5 SUITE	CAT. 1 SOLO	CAT. 2 SOLO	ADVANCE PAYMENT	NOTE
Exploring Alaska's Coastal Wilderness – Page 20	2019	\$6,990	\$7,740	\$8,290	\$9,200	\$10,250	\$10,490	\$11,610	\$750	Sample Airfares: Seattle/Juneau, Sitka/Seattle (or vice versa): Economy from \$400; Business from \$800.
	2020	\$7,100	\$7,850	\$8,340	\$9,260	\$10,290	\$10,640	\$11,770		
Treasures of the Inside Passage: Alaska and British Columbia – Page 28	2019	\$9,990	\$10,640	\$11,190	\$11,990	\$12,890	\$14,990	\$15,960	\$1,500	Sample Airfares: Seattle/Juneau, Sitka/Seattle (or vice versa): Economy from \$400; Business from \$800.
	2020	\$10,290	\$10,960	\$11,530	\$12,350	\$13,280	\$15,440	\$16,440		

Prices quoted in this brochure are valid as of the time of printing, are subject to modification, and are not guaranteed until booking and required deposit is made. See our website at [expeditions.com](http://expeditions.com) for the most up-to-date pricing.



## NATIONAL GEOGRAPHIC SEA BIRD & NATIONAL GEOGRAPHIC SEA LION

**CAPACITY:** 62 guests in 31 outside cabins.

**REGISTRY:** United States. **OVERALL LENGTH:** 152 feet.

**PUBLIC AREAS:** Our twin sister ships feature a library; global market; lounge with full-service bar and facilities for films, slide shows and presentations; observation deck; partially covered sun deck with chairs and tables, and LEXspa. Our “open bridge” provides guests an opportunity to meet our officers and captain and learn about navigation.

**MEALS:** Served in single seatings with unassigned tables for an informal atmosphere and easy mingling. Breakfasts are wide-selection buffets and lunch is often served family style. Dinners are primarily served plated. Menu emphasizes local fare.

**CABINS:** All face outside with windows, private facilities, and climate controls.

**EXPEDITION EQUIPMENT:** Bow camera, hydrophone, kayaks, fleet of paddleboards, splash-cam, underwater video camera, video microscope, and expedition landing craft.

**SPECIAL FEATURES:** Guest internet access. A certified photo instructor and a video chronicler are on board all voyages. An undersea specialist is on board in Alaska.

**WELLNESS:** The vessel is staffed by a wellness specialist and features exercise equipment, LEXspa, and outdoor stretching area.

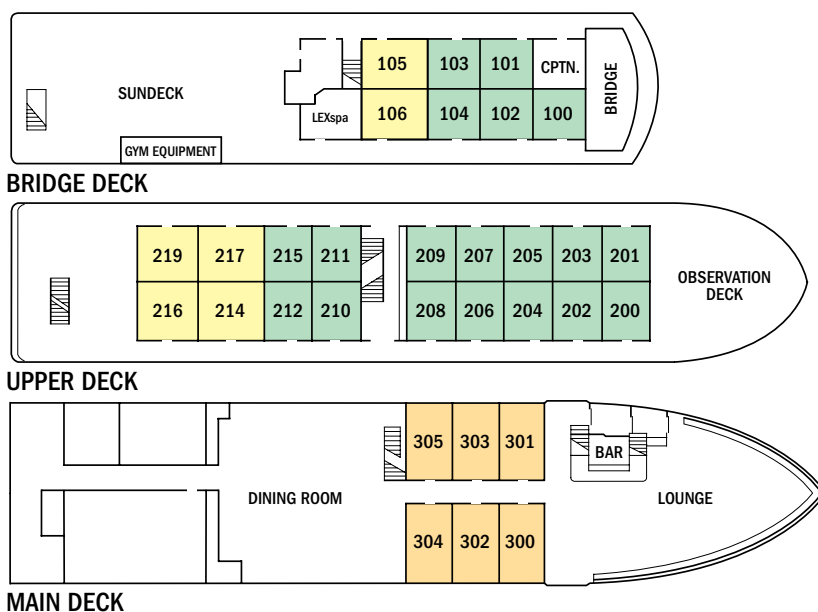





Left to right: Sightseeing from bow; *National Geographic Sea Bird*; bartender in our newly refurbished lounge; dining room where meals are served in single seating with unassigned tables for easy mingling; Category 2 cabin freshly redesigned; twin beds can be pushed together to form a double bed in Category 3 cabins on the upper decks

**CATEGORY 1:** Main Deck #300-305—Conveniently positioned between the dining room and lounge, these cabins feature two single lower beds, and a large view window.

**CATEGORY 2:** Bridge Deck #100-104; Upper Deck #200-212, 215—These well-located cabins include two lower single beds and a view window.

**CATEGORY 3:** Bridge Deck #105, 106; Upper Deck #214, 216, 217, 219—These cabins feature a seating unit with table and two large view windows. Upper Deck cabins

include two lower single beds which can convert to a double bed and a pull-out single bed for a third person; Bridge Deck cabins include two lower single beds only.

Note: Solo Occupancy cabins are available in Categories 1 and 2 only. Third person rates are available in certain categories at one half the double occupancy rate.

Shared Accommodations: Shares can be arranged at the double occupancy rate in Categories 1 and 2 only.

Prices are per person, double occupancy unless indicated as solo.

ITINERARY	YEAR	CAT. 1	CAT. 2	CAT. 3	CAT. 1 SOLO	CAT. 2 SOLO	ADVANCE PAYMENT	NOTE
Exploring Alaska's Coastal Wilderness – Page 20	2019	\$5,990	\$6,990	\$7,990	\$8,990	\$10,490	\$750	Sample Airfares: Seattle/Juneau, Sitka/Seattle (or vice versa): Economy from \$400; Business from \$800.
Wild Alaska Escape: Sitka to Juneau – Page 24	2019	\$4,390	\$4,990	\$5,990	\$6,590	\$7,490	\$750	Sample Airfares: Seattle/Juneau, Sitka/Seattle (or vice versa): Economy from \$400; Business from \$800.
	2020	\$4,420	\$5,140	\$6,170	\$6,630	\$7,710		
Wild Alaska Escape: Juneau to Ketchikan – Page 25	2020	\$4,420	\$5,140	\$6,170	\$6,630	\$7,710	\$750	Sample Airfares: Seattle/Juneau, Ketchikan/Seattle (or vice versa): Economy from \$415; Business from \$750.
A Remarkable Journey to Alaska, British Columbia & Haida Gwaii – Page 32	2019	\$10,900	\$12,450	\$14,530	\$16,350	\$19,860	\$1,500	We will gladly assist in making your air arrangements. Please call for airfares from your departure city.
	2020	\$11,230	\$12,820	\$14,970	\$16,840	\$20,460		

Prices quoted in this brochure are valid as of the time of printing, are subject to modification, and are not guaranteed until booking and required deposit is made. See our website at [expeditions.com](http://expeditions.com) for the most up-to-date pricing.



## NATIONAL GEOGRAPHIC ORION

**CAPACITY:** 102 guests in 53 outside cabins.

**REGISTRY:** Bahamas. **OVERALL LENGTH:** 338 feet.

The state-of-the-art *National Geographic Orion* is a fully stabilized, ice-class vessel with an ice reinforced hull.

*National Geographic Orion* is at home navigating polar ice, as well as island harbors in the South Pacific.

**PUBLIC AREAS:** Outdoor café, lounge with bar and state-of-the-art facilities, restaurant, sundeck, reception desk, observation lounge and library, global gallery, and marina platform. The whirlpool hot tub doubles as a plunge pool in warm climates. Our “open bridge” allows guests to meet our captain and officers and learn about navigation.

**MEALS:** All meals are served in a single seating with unassigned tables for an informal atmosphere and easy mingling. The cuisine is international with local flair, featuring tastes of the regions we explore.

**CABINS:** All cabins feature ocean views, private facilities, climate controls, and a flat-screen TV. Equipped with Ethernet and Wi-Fi connections and USB ports for mobile devices. Some cabins have French balconies. Single cabins in Category 1 and Category 3 include #301, 322, 323, and 512.

**EXPEDITION EQUIPMENT:** Zodiac landing craft, a fleet of 24 double kayaks, a crow’s nest camera, a hydrophone, underwater video cameras, video microscope, and a Remotely Operated Vehicle (ROV).

**SPECIAL FEATURES:** Laundry, a full-time doctor, National Geographic photographer and Lindblad-National Geographic certified photo instructor, plus an undersea specialist and video chronicler.

**WELLNESS:** A wellness specialist, fitness center, LEXspa treatment room and sauna are on board.

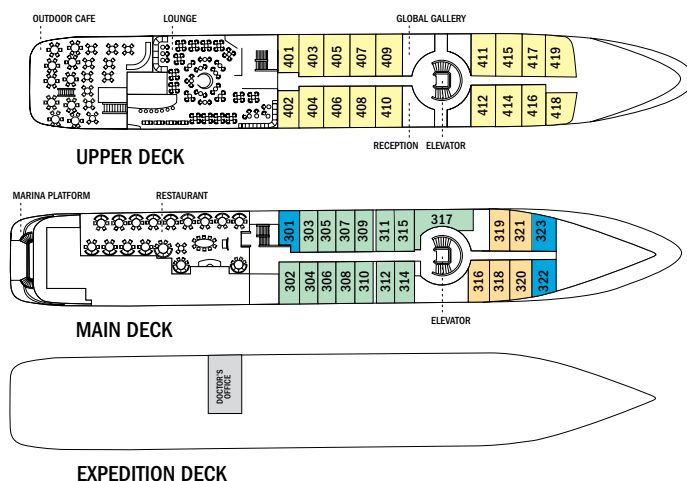
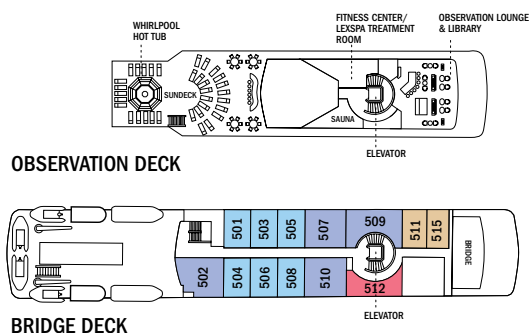



Left to right: Main lounge; *National Geographic Orion*; our hotel staff will do whatever it takes to ensure your comfort and satisfaction aboard; *Orion*'s dining room features no assigned seating for casual, easy mingling; Category 3 suite with window; Category 6 Owner's suite with French balcony.

**CATEGORY 1:** Main Deck with oval window #316, 318, 319-321

**CATEGORY 2:** Main Deck with oval window #302-312, 314, 315, 317

**CATEGORY 3:** Upper Deck—Suite with window #401-412, 414-419

**CATEGORY 4:** Bridge Deck—Deluxe suite with window #511, 515

**CATEGORY 5:** Bridge Deck—Suite with French balcony #501, 503-506, 508

**CATEGORY 6:** Bridge Deck—Owner's suite with French balcony #502, 507, 509\*, 510

\*Cabin 509 has two windows in lieu of a French balcony.

**CATEGORY 1 SOLO:** Main Deck with oval window or two portholes #301, 322, 323

**CATEGORY 3 SOLO:** Bridge Deck—Suite with two windows #512

Note: Sole occupancy cabins available in Categories 1 and 3. Shared accommodations available in Categories 1 and 2.

Note: Third person rates available at one-half the double occupancy rate in designated triple occupancy cabins.

Prices are per person, double occupancy unless indicated as solo.

ITINERARY	YEAR	CAT. 1	CAT. 2	CAT. 3	CAT. 4	CAT. 5	CAT. 6	CAT. 1 SOLO	CAT. 3 SOLO	ADVANCE PAYMENT	NOTE
<b>Bering Sea Wilderness: Pribilofs, Katmai, and Kodiak – Page 36</b>	2020	\$17,040	\$18,310	\$20,400	\$24,650	\$28,190	\$32,810	\$25,560	\$30,600	\$2,500	Sample Airfares: Round-trip Seattle/Anchorage: Economy from \$400; First class from \$900. Charter airfare: Anchorage/Nome from \$305.
<b>Across the Bering Sea: From Katmai to Kamchatka – Page 40</b>	2020	\$27,140	\$29,090	\$31,360	\$39,310	\$45,360	\$52,490	\$40,720	\$47,030	\$3,000	Sample Airfares: Round-trip Seattle/Anchorage: Economy from \$400; Business from 1,200. Charter airfare from \$305 (Nome/Anchorage).

Prices quoted in this brochure are valid as of the time of printing, are subject to modification, and are not guaranteed until booking and required deposit is made. See our website at [expeditions.com](http://expeditions.com) for the most up-to-date pricing.



ALASKA'S COASTAL WILDERNESS EXTENSION

## DENALI NATIONAL PARK & PRESERVE

**EXTEND YOUR COASTAL EXPEDITION AND EXPLORE THE WILDS OF ALASKA'S INTERIOR** in Denali National Park & Preserve. Enjoy exclusive access to Denali's pristine back-



country and choose from a range of daily activities, paced for all endurance levels. Immerse yourself in the remote wildness and north county charm of the North Face Lodge. Return to Anchorage via the historic Alaska Railroad, riding the rails through spectacular mountain landscapes.

**7 DAYS PRE or POST-VOYAGE EXTENSION  
FROM: \$6,690**

### ITINERARY AT A GLANCE

Day 1: Fairbanks, Alaska  
Day 2: Fairbanks/Denali National Park & Preserve  
Days 3–5: Denali National Park & Preserve  
Day 6: Denali National Park & Preserve/Anchorage  
Day 7: Sitka or Juneau

- ▶ Visit [expeditions.com/Denali](https://expeditions.com/Denali) for a day-by-day itinerary. Or call to speak with an Expedition Specialist.
- ▶ Visit [expeditions.com/denalinow](https://expeditions.com/denalinow) to watch a short video on this Alaska experience.



## TUTKA BAY LODGE

**EXPERIENCE THE TREASURES OF ALASKA'S** pristine Kachemak Bay and the wild Kenai Peninsula during a stay at Tutka Bay Lodge, a National Geographic Unique Lodge of the World. Choose among abundant options for exploring Tutka Bay's breathtaking natural surroundings, from a deep-sea fishing trip to a float plane excursion in search of Alaskan brown bears. Kayak among untamed islets and hike a winding network of trails through old-growth spruce forests. Relax in the evenings with delicious, locally-sourced meals and a seat by the bonfire.

### 5 DAYS POST-VOYAGE EXTENSION FROM: \$6,525

#### ITINERARY AT A GLANCE

Day 1:	Anchorage, Alaska
Day 2:	Tutka Bay Lodge
Day 3:	Tutka Bay Lodge
Day 4:	Tutka Bay Lodge
Day 5:	Tutka Bay/Anchorage

▶ Visit [expeditions.com/TutkaBay](https://expeditions.com/TutkaBay) for a day-by-day itinerary. Or call to speak with an Expedition Specialist.

These two extensions can be taken with either our *Bering Sea Wilderness: Pribilofs, Katmai & Kodiak* or *Across the Bering Sea: From Katmai to Kamchatka* itineraries (see pages 34-41). Call an Expedition Specialist for assistance.



## WINTERLAKE LODGE

**DELVE INTO THE BREATHTAKING WILDERNESS** of the Alaska Range during a stay at Winterlake Lodge, a National Geographic Unique Lodge of the World. Fly by seaplane to this lakeside sanctuary set along the historic Iditarod Trail, and take advantage of abundant opportunities to explore the surrounding landscape, from fly-fishing in a secluded river to hiking across a glacier. Relax in the sauna or stroll along the lakeshore in the late evening sunlight after each day's adventures.

### 5 DAYS POST-VOYAGE EXTENSION FROM: \$6,399

#### ITINERARY AT A GLANCE

Day 1	Anchorage, Alaska
Day 2	Winterlake Lodge
Day 3	Winterlake Lodge
Day 4	Winterlake Lodge
Day 5	Anchorage

▶ Visit [expeditions.com/Winterlake](https://expeditions.com/Winterlake) for a day-by-day itinerary. Or call to speak with an Expedition Specialist.



# TAKE ADVANTAGE OF OUR SPECIAL OFFERS

## **SPECIAL AIR OFFERS—BOOK BY JUL. 31, 2019.**

Offers are available on select departures, and based on availability at the time of booking. On voyages with complimentary air offers, airfare is based on economy group flights that must be ticketed by Lindblad Expeditions. In the case that Lindblad's group or charter flights are no longer available at time of booking, we reserve the right to issue a credit. All offers are valid for new bookings only, subject to availability at the time of booking, and may not be combined with other offers and pre- and post-extensions. Call for details.

**SOLO EXPLORERS OFFER:** Book by July 31, 2019 to have the solo premium waived on solo cabins on select departures of *Exploring Alaska's Coastal Wilderness*, *Wild Alaska Escape: Sitka to Juneau*, *Treasures of the Inside Passage*, and *Remarkable Alaska, British Columbia & Haida Gwaii*.

**EXCLUSIVE ALASKA FAMILY OFFER:** On select 2019 departures of *Exploring Alaska's Coastal Wilderness* (pages 20-21), every two full-paying adults are welcome to bring a child (22 and under) at 50% off and a second child for FREE. Savings do not apply to extensions and are for new bookings only. Please call for details.

**BRINGING THE KIDS:** We believe sharing an expedition with your kids or grandkids is a life-enhancing experience. So take \$500 off for each child under the age of 18 on any departure.

## **WILD ESCAPES INTRODUCTORY OFFER: TRAVEL**

**WITH 6 OR MORE & SAVE 10%:** Traveling with family or sharing an adventure with friends often doubles the pleasure. So, we're doubling the incentive on select departures of our two *Wild Alaska Escapes* itineraries (pages 22-25)—save 10% when traveling as a group of 6 or more. Simply book by July 31, 2019.

**BAR TAB AND CREW TIPS:** We will cover your bar tab and tips to the ship's crew on all Bering Sea departures aboard *National Geographic Orion*.

**BACK-TO-BACK SAVINGS:** Save 10% on any consecutive journeys taken on board our expedition ships. This savings is applicable on voyage fares only, and are not valid on extensions or airfare.

**TRAVELING AS A GROUP:** Save 5% when traveling as a group of 8 or more people. Take advantage of these great savings, while enjoying traveling with your friends and family. This savings is applicable to voyage fares only, and is not valid on extensions or airfare. Deposit, final payments, and cancellation policies for group travel vary from our regular policies.

**COMBINING OFFERS:** Certain offers may be combinable, up to two savings opportunities except where noted otherwise. For example, travel with a group of eight or more on back-to-back expeditions, and take advantage of both savings!



## INCLUSIVE PRICING MEANS VALUE + EXPERIENCES

We include just about everything you have the opportunity to do as part of your expedition aboard ship and ashore. The only things not included are those of a personal nature—internet usage, wellness treatments and other specialized arrangements.

### ABOARD SHIP

- ✓ All meals and nonalcoholic beverages
- ✓ 24-hour coffee, tea and soda on demand
- ✓ Hors d'oeuvres and snacks during nightly Recap
- ✓ Environmentally-friendly refillable water bottle
- ✓ Morning stretch classes with wellness specialist
- ✓ Fitness equipment
- ✓ Access to reference books and board games in the library
- ✓ The guidance and company of our expedition staff

### ASHORE

- ✓ Special access permits, park fees, port taxes
- ✓ Transfers to and from group flights
- ✓ The expertise of our expedition staff

### ACTIVITIES

- ✓ Expedition landing craft explorations
- ✓ Kayaking
- ✓ Stand-up paddleboarding
- ✓ Presentations & photo instruction, including a special Alaska Whale Foundation presentation on select departures

Photo Credits: Steve Bloom Images/Alamy, Linda Burback, Marc Cappelletti, Ken Carlson, Ralph A. Clevenger, Stewart Cohen, Rab Cummings, Jennifer Davidson, Patrick J. Endres, Doug Gould, Mike Greenfelder, Ralph Lee Hopkins, Jan Butchofsky Houser, John Hyde, David Jaffe, Alex Krowiak, Jeff Litton, Jeff Mauritzen, Michael Melford, Emily Mount, Carlos J. Navarro, Andrey Nekrasov/Alamy, Flip Nicklin, Michael S. Nolan, Andrew Peacock, Douglas Peebles Photography/Alamy, Rich Reid, Gerry Reynolds/Alamy, Marco Ricca, Krista Rossow, Kevin Schafer, Jeff Schultz/superstock, Max Seigal, Susan Seubert, Paul Souders, David Spiegel, Ian Strachan, Brenda Tharp, Evan Thornton, David Vargas, Craig Wilson.

## RESERVATION INFORMATION

**Terms & Conditions:** For complete terms and conditions please visit [www.expeditions.com/terms](http://www.expeditions.com/terms)

**Costs Include:** All accommodations aboard ship or in hotels per itinerary or similar, all meals and nonalcoholic beverages\* aboard ship, meals on land as indicated, air transportation where indicated as included, all shore excursions except flightseeing, sightseeing and entrance fees, special access permits, transfers to and from group flights, use of kayaks (where available), tips (except to ship's crew), taxes and service charges, services of a ship physician, and services of our expedition staff.

\*All departures aboard *National Geographic Orion* include alcoholic beverages aboard ship (excepting certain super-premium brands) and tips to the ship's crew.

**Not Included:** Air transportation (except where shown as included), extensions, passport, visa, immigration fees, meals not indicated, travel protection plan, items of a personal nature such as alcoholic beverages, internet access, voyage DVD, flightseeing, laundry. Gratuities to ship's crew are at your discretion.

**Airfare:** For all programs, airfare is an additional cost unless otherwise indicated. Sample airfares are subject to change. We will gladly assist in making your air arrangements for a \$50 per person service fee.

**Reservations:** To reserve your place, an advance payment is required at the time of reservation. A per-person deposit begins at \$750 and is dependent upon itinerary.

**Final Payment:** For expeditions aboard all ships with the exception of *Endurance*, *Explorer* and *Orion*, payment is due 90 days prior to departure. For expeditions aboard *Endurance*, *Explorer* and *Orion*, payment is due 120 days prior to departure. Payment schedules may vary for certain longer voyages, due to high demand for these voyages. We reserve the right to cancel your reservation if payment has not been received by final payment due date."

**Travel Protection Plan:** We strongly recommend that you take advantage of our Travel Protection Plan. This plan offers comprehensive coverage to protect you from cancellation fees, costs incurred due to trip delays/interruption, medical assistance, and damaged or lost baggage, and provides medical assistance and evacuation during your travels. Our Travel Protection Plan is available for U.S. and Canadian residents only, and may be purchased any time prior to final payment due date. If you are not satisfied for any reason, you may return your plan within 10 days after purchase. Your premium will be refunded if canceled within 10 days, provided you have not already departed on the trip or filed a claim. When so returned, the coverage under the plan is void from the original date of purchase.

**Responsibility and Other Terms & Conditions:** Certain provisions concerning, among other things, limitations of Lindblad Expeditions' and the National Geographic Society's liability for loss of property, injury, illness or death during the voyage will be provided to all guests on the ship's ticket sent prior to departure, and are also available on our website at [www.expeditions.com/terms](http://www.expeditions.com/terms), or upon request. By registering for a trip, the guest agrees to all such terms and conditions.

**Note:** Itineraries and prices listed in this brochure are as of publication date and are subject to change. Under normal conditions the total expedition price is guaranteed at the time of booking. However, our expedition pricing is determined far in advance of initial departure on the basis of then-existing projections of fuel and other costs. In the event of increases in those costs, including but not limited to increases in the price of fuel, currency fluctuations, increases in government taxes or levies, or increased security costs, we reserve the right to adjust the price of your expedition or add a surcharge to cover such unexpected increases. We will always provide an explanation of the reason for increase in costs.

**Cancellation Policy:** Cancellation penalties may apply after payment is received. Please visit [www.expeditions.com/terms](http://www.expeditions.com/terms) for complete cancellation policies.

Unused services or items included in our programs are non-refundable.

©2019 Lindblad Expeditions

Lindblad Expeditions and the Eye are the trademarks of Lindblad Expeditions. All rights reserved.

NATIONAL GEOGRAPHIC and the Yellow Border are the trademarks of the National Geographic Society. All rights reserved.

**For Reservations: Contact your travel advisor or Lindblad Expeditions**

**1.800.EXPEDITION (1.800.397.3348)**

**Reservation Hours: Monday – Friday 9am – 9pm ET**

**Saturday & Sunday 10am – 5pm ET**

**Lindblad Expeditions, Inc., 96 Morton Street, New York, NY 10014**

**Phone: 212.261.9000 • Fax: 212.265.3770**

**For additional information and online reservations,  
visit us on the Web: [www.expeditions.com](http://www.expeditions.com)**

Account Number:



1.800.EXPEDITION | WWW.EXPEDITIONS.COM

Printed on 10% recycled content paper with soy-based inks. We recommend that you pass this along for others to enjoy or recycle.

AKC-060



## SPECIAL 6X6 OFFER

Choose one of our 6-day **WILD ESCAPES**, travel with 6 or more—and get **10% OFF** Select departures. See pages 22-25 and call for details.

## PLUS: SOLO TRAVEL SAVINGS

Book now and waive the premium on select 2019 departures.

See page 52